

1 Safety notice:

- 1.1 Please read use manual carefully before you use projector.
- 1.2 National standard power cable and power cord with grounding is suggested,so as to ensure stable power supply.
- 1.3 Please use the same power Voltage with the projector marked.
- 1.4 Please not open the projector,otherwise factory will not afford warranty service.
- 1.5 No pecking to the projector lamp as the projector is working, otherwise easy to damage your eyes.
- 1.6 In the projector ventilation holes,please don't cover with the cloth,carpet and other materials.
- 1.7 No waterproof function, please keep projector away the rain or moisture,and can't put some liquid items such as vase cup those.
- 1.8 In order prevent power shock,please keep away rain or water or moisture.
- 1.9 Turn off and cut off the power supply, if long time not use projector.
- 1.10 Use the originally foam or other anti-shock material to protect projector,if you need transport this projector.
- 1.11 Contact with the agency,don't repair by yourself.If you find the projector have problem.

Maintain indication:
1 year warranty from factory,more warranty information,please contact with agency (warranty service is not including the frame, Manual,package,and some subjective idea about the video sound image aspects).

2 Interface introduction



- | | | |
|--|------------------|---|
| 1 Lens
(please don't staring the lamp as projector working) | 7 Right | 14 AV input |
| 2 Manual focus | 8 Left | 15 USB input slot |
| 3 Keystone | 9 ESC | 16 USB output slot
(Or power supply) |
| 4 Power input | 10 Input | 17 HDMI input slot |
| 5 Power button | 11 IR receiver | 18 SD card slot |
| 6 OK | 12 VGA | 19 Light on |
| | 13 Earphone slot | |

3 Remote control introduction



Notice:
Please don't take the old and new battery mixed use,avoid power shortage.
If long time not use remote control,please take the battery out,avoid Battery leakage corrosion.
As you use remote control,please take the remote control with the projector infrared ray receiver slot.

4 Use manual

4.1 Preparation before light on

- 4.1.1 As following picture,connect the power adaptor.



4.2 Power on/Power off

Press "Power" button or press remote control to get the projector on.



4.3 Multimedia boot screen

As the projector start working,the screen display (about 2-5 seconds) then come into the multimedia screen.



4.4 Focus&keystone

4.4.1 Keystone
In sometimes,the images which projected on the wall is a little twisted as a ladder,we could take a keystone button "Keystone" to adjust it.The keystone technology is the method to get the image normalization by digital or optical technology.

4.4.2 Image focus

Put the projector vertical to the projector screen or white wall, adjust the keystone "Keystone" ,until the image is clearly enough,then the focus is finished. during the focusing,you could display video or display the menu to check the focus adjust.



Solution
Our projector provide optical keystone function,you could turn the keystone adjust the image.



Solution
Our projector have no level keystone function,and if have this problem,the reason is your haven't keep the projector vertical with the project screen, and the solution is,adjust the projector's position,and keep the projector on the same level.

5 Projector connection introduce

5.1 Connection introduce



*Could connect multi-device and applications.

5.2 Multi-media connection

- 5.2.1 Insert the USB/SD card into the accordingly slot.(see picture).



- 5.2.2 Choose multi-media signal source (factory setting USB/SD card outlet).

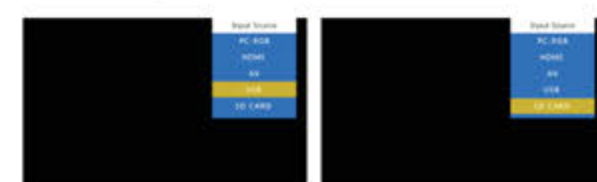

Multimedia Supported format

Multi-media	Audio file	MP3/WMA/ASF/OGG/AAC/WAV
	Audio file	JPEG/BMP/PNG
	Video file	3GP(H.263,MPEG4)/AVI(XVID,DVX,H.264)/MKV(XVID,H.264,DVX)/FLV(FLV1)/MOV(H.264)/MP4(MPEG4,AVC)/MPG(MPEG1)/VOB(MPEG2)/MPG(MPG-PS)/RMVB(RV40)/RM
	text file	TXT

- 5.2.3 Choose the content which you need display: Video,Music,Photo Text.



- 5.2.4 Choose the file which you want to display, press "OK" display or stop.



5.3 AV Video equipment connect

Use 3 in 1 cable video convert cable,connect projector AV slot,the connect method like the picture,as connected,choose the signal source Video.

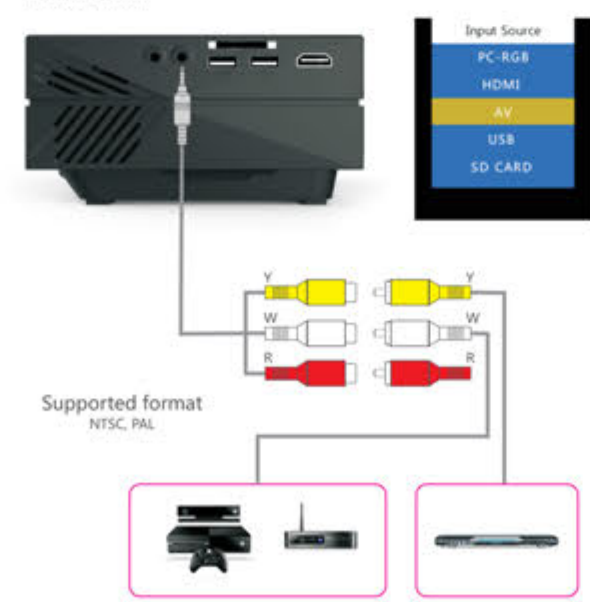

Supported format
NTSC, PAL

5.4 HDMI equipment connect

- 5.4.1 HDMI slot could connect computer and all the device with HDMI slot.As connected,choose the signal source HDMI.



- 5.4.2 Our projector support HDMI slot and MHL cable and iPush, could put your mobile and tablet content projector.

*Please consult the factory or agency.
*This function need your device supported and cable affected.

5.5 3.5mm Audio device connect

- 5.5.1 Could connect 3.5mm earphone and speaker equipments.



- 5.6 Other connect
USB output 5V for mobile,tablet power supply.



6 Menu guide

6.1 Menu set

6.1.1 Image menu
Remote control use guide:press Menu key,then the main menu come out,press "Left/Right" key,choose come into the image submenu, press key "Up/Down" ,choose key the program which you want to adjust,then press OK key come into set.

In the image you could set the following models,such as image mode(text video picture user defined) colour temperature (cold hot,user defined),zoom mode(auto,4,3,16,9 point-to-point,panoramic,zoom), zoom2,just scan,denoise(close,low, middle,high,tactily approve)



6.1.2 Audio submenu

Press MENU key,and get the main menu,then press "Left/Right" choose audio submenu,press "Up/Down" choose the items which you need adjust,then press OK key come into set.

In the audio you could set the sound mode:music,powersport, user balance(-50 ~ +50),auto volume(open,off) surround(close, surround,SRS) balance(120Hz, 500Hz,1.5Hz,5kHz,10kHz).

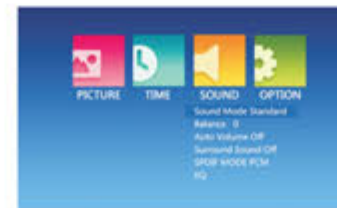

6.1.3 Time Sub-menu

Press MENU key on the remote control,and get the main menu, then press "Left/Right" choose time submenu,press "Up/Down" choose the items which you need adjust,then press OK key come into set.

In the set,set the language in menu language set back to factory set and software upgrade.



6.1.4 Set Sub-menu

Press MENU key on the remote control,then press "Left/Right" key to set submenu,Press "Up/Down" key choose the program which need adjust,and press OK key come to set.

Set the projector language,back to factory set and software upgrade.

6.2 Display menu use guide

You could control the content by the display menu.



7 Technology features

7.1 Basic parameters

Imaging Technology	TFT LCD	Color Reproduction	16.7K
Brightness	1000 Lumens	Keystone	Manual correction ±15°
Contrast	1000:1	Power Voltage	100/240V 50/60Hz
Native Resolution	800x480	Integrated watt	50W(max)
Highest Resolution	1920x1080	Input	USB/2/SD/VGA/HDMI/AV
Light	LCD/LED	Output	earphone USB(5v-500MA)
Life Span	30,000+ hours	Speaker	802W
Lens	Multichip Coated	System Support	Support multi-media
Throw Distance	1-4M	Language support	Support 23 Languages
Screen Size	34-130 inches	Unit Size	1 7.4" x 5.7" x 2.1"
Aspect Ratio	4.3/16.9	Net Weight	0.98 KG 1.98 lbs.

7.2 Project Distance & Size

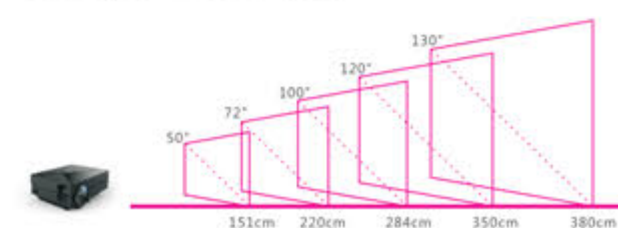

PYLE
PyleAudio.com

Projector User Manual



PRJG82